

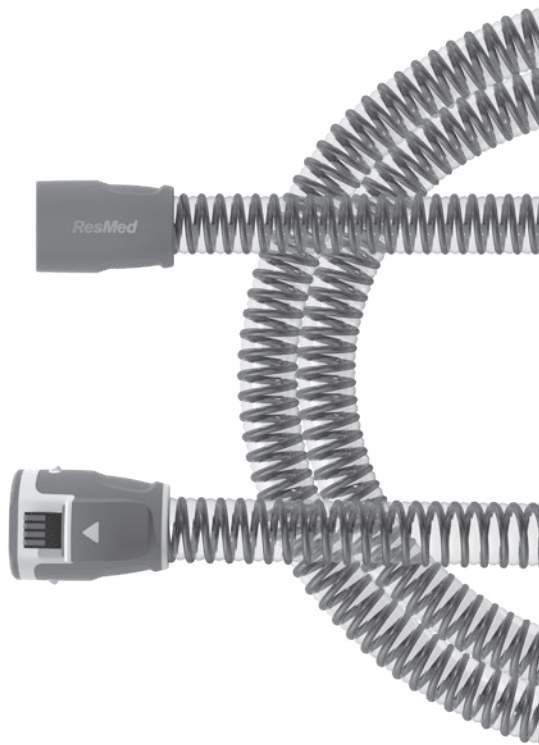

**ResMed**

ClimateLineAir™ 11



User guide

English

## About the ClimateLineAir 11

### CAUTION

In the US, Federal law restricts this device to sale by or on the order of a physician.

The ClimateLineAir™ 11 is a heated breathing tube that delivers air to a compatible mask. When used with the device humidifier, ClimateLineAir heated air tubing allows you to use the Climate Control feature.

Please read this entire user guide together with your device user guide before using your ClimateLineAir 11 heated air tubing.

**Note:** Only use the ClimateLineAir 11 with compatible devices.

## Setting up

To set up the device and tubing:

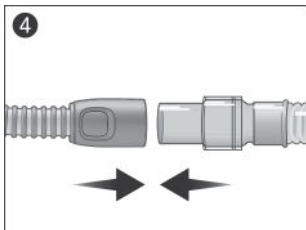
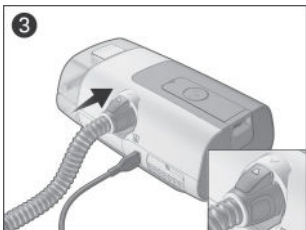

1. Make sure the device is connected and turned on.
2. Hold the cuff of the heated air tubing and line up the heated air tubing with the outlet connector at the rear of the device.
3. Push the cuff firmly into place. **ClimateLine connected** will briefly display on the device screen.
4. Connect the assembled mask to the free end of the heated air tubing.

**Note:** The electrical connector end of the heated air tubing is only compatible with the air outlet at the device end and should not be fitted to the mask.

# Device Settings

## Climate Control

Climate Control is designed to make therapy more comfortable by enabling constant temperature and maintaining humidity.

This feature:

- delivers comfortable humidity level and temperature during therapy.
- maintains the set temperature and relative humidity during sleep to prevent dryness in the mouth
- can be set to either **Auto** or **Manual**
- is only available when both the ClimateLineAir and HumidAir™ tub are attached.

### Climate Control - Auto setting

**Auto** is the recommended and default setting. It is designed to make therapy as easy as possible so there is no need to change the temperature or humidity settings.

- Sets the tube temperature to Auto (80°F/27°C). If the air in the mask is too warm or too cold, you can adjust the tube temperature to anywhere from 60 to 86°F (16 to 30°C) or turn it off completely
- Adjusts the humidifier output to maintain a constant, comfortable humidity level of 85% relative humidity
- Protects against rainout (water droplets in the heated air tubing and mask).

### Climate Control - Manual setting

**Manual** is designed to offer more flexibility and control over settings and offers the following:

- Temperature and humidity can be adjusted to find the most comfortable setting
- Temperature and humidity level can be set independently
- Rainout protection is not guaranteed. If rainout does occur, first try increasing the tube temperature

- If the air temperature becomes too warm and rainout continues, try decreasing the humidity.

**Note:** If Climate Control is set to **Manual**, the **Auto** Tube Temperature setting is not available.

## Humidity Level

The humidifier moistens the air and is designed to make therapy more comfortable.

- If you are getting a dry nose or mouth, turn up the humidity
- If you are getting any moisture in your mask, turn down the humidity.
- You can set the **Humidity Level** to Off or between 1 and 8, where 1 is the lowest humidity setting, and 8 is the highest humidity setting.

To update the settings for Tube Temperature, Climate Control, or Humidity Level, tap **MY OPTIONS** from the **Home** screen, go down the list of options, and select the setting. Refer to your device user guide for more information on how to update the device settings.

## Cleaning and caring for your tubing

### WARNING

- Clean the device and its components according to the schedules shown in this guide, to maintain the quality of the device and to prevent the growth of germs that can adversely affect your health.
- If any visible deterioration of a system component is apparent (cracking, discoloration, tears etc.), the component should be discarded and replaced.

### CAUTION

- Do not use bleach, chlorine, alcohol, or aromatic-based solutions, moisturizing or antibacterial soaps or scented oils to clean the device, the humidifier or air tubing. These solutions may cause damage or affect the humidifier performance and reduce the life of the products. Exposure to smoke, including cigarette, cigar or pipe smoke, as well as ozone or other gases, may damage the device. Damage caused by any of the foregoing, will not be covered by ResMed's limited warranty.

### Disconnecting

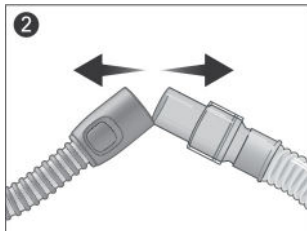
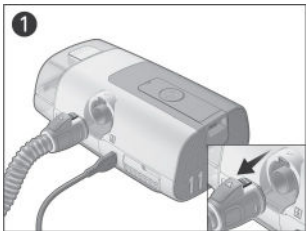

1. Pinch the cuff of the air tubing, and gently pull it away from the device.
2. Hold both the cuff of the air tubing and the swivel of the mask, then gently pull apart.

**Note:** Only hold and pull the cuff of the air tubing. Do not hold or pull the tubing itself as it may cause damage.

## **Cleaning**

The following instructions are for home cleaning. Instructions for reprocessing tubing intended for multi-patient re-use can be found in the clinical guide.

You should clean the air tubing weekly as described.

1. Wash the air tubing in warm water using a household dishwashing liquid. It should not be washed in temperatures higher than 149°F (65°C). Do not wash in a dishwasher or washing machine.
2. Rinse the air tubing thoroughly in water.
3. Allow to dry out of direct sunlight and/or heat.

## **Checking**

You should regularly check the air tubing for any damage. If there are any holes, tears, or cracks, you should replace it.

## **Reassembly**

When the air tubing is dry, you can reconnect it to the device.

1. Connect the air tubing firmly to the air outlet located on the rear of the device.
2. Connect the free end of the air tubing firmly onto the assembled mask.

## **Troubleshooting**

If you have any problems, refer to the troubleshooting section of your device user guide or [www.resmed.com](http://www.resmed.com).

For any serious incidents that occur in relation to this device, these should be reported to ResMed and the competent authority in your country.

## Technical specifications

### Environmental conditions

Operating temperature:	+41°F to +95°F (+5°C to +35°C)
Operating humidity:	10 to 95% relative humidity, non-condensing
Operating altitude:	Sea level to 9,870' (3,010 m); air pressure range 700 hPa to 1060 hPa;
Storage and transport temperature:	-13°F to +158°F (-25°C to +70°C)
Storage and transport humidity:	5 to 95% relative humidity, non-condensing

---

### Design life

Air tubing:	6 months
-------------	----------

---

Maximum working pressure of heated air tubing:	25 cmH <sub>2</sub> O
--	-----------------------

---

Maximum working temperature of heated air tubing:	+60°F to 86°F (16°C to 30°C)
---	------------------------------

---

### Air tubing dimensions

Air tubing	Material	Length	Inner-diameter
ClimateLineAir 11	Flexible plastic and electrical components	6'6" (2 m)	0.6" (15 mm)

---

Heated air tubing temperature cut-out: +106°F (41°C)

---

### Note:

- The manufacturer reserves the right to change these specifications without notice.



## Resistance to flow

The table illustrates the resistance to flow of the air tubing:





Air tubing	At flow (L/min) with pressure of 20 cm H <sub>2</sub> O	Resistance to flow (cm H <sub>2</sub> O/l/min)
		Air tubing only
ClimateLineAir	30	0.0100
	15	0.0077

## Compliance

The table illustrates the compliance of the air tubing:

Air tubing	Compliance (cm H <sub>2</sub> O/L/min) with pressure of 60 cm H <sub>2</sub> O
	Air tubing only
ClimateLineAir 11	0.500

## Symbols

 Temperature limitation.  Humidity limitation.  Operating altitude.  Atmospheric pressure limitation.  Manufacturer.

See symbols glossary at [ResMed.com/symbols](http://ResMed.com/symbols).



### Environmental information

This device should be disposed of separately, not as unsorted municipal waste. To dispose of your device, you should use appropriate collection, reuse and recycling systems available in your region. The use of these collection, reuse and recycling systems is designed to reduce pressure on natural resources and prevent hazardous substances from damaging the environment.

If you need information on these disposal systems, please contact your local waste administration. The crossed-bin symbol invites you to use these disposal systems. If you require information on collection and disposal of your ResMed device please contact your ResMed office, local distributor or go to [ResMed.com/environment](http://ResMed.com/environment).

## Limited warranty

ResMed Pty Ltd (hereafter 'ResMed') warrants that your ResMed product shall be free from defects in material and workmanship from the date of purchase for the period specified below.

Product	Warranty period
<ul style="list-style-type: none"><li>• Mask systems (including mask frame, cushion, headgear and tubing)—excluding single-use devices</li><li>• Accessories—excluding single-use devices</li><li>• Flex-type finger pulse sensors</li><li>• Humidifier water tubs</li></ul>	90 days
<ul style="list-style-type: none"><li>• Batteries for use in ResMed internal and external battery systems</li></ul>	6 months
<ul style="list-style-type: none"><li>• Clip-type finger pulse sensors</li><li>• CPAP and bilevel device data modules</li><li>• Oximeters and CPAP and bilevel device oximeter adapters</li><li>• Humidifiers and humidifier cleanable water tubs</li><li>• Titration control devices</li></ul>	1 year
<ul style="list-style-type: none"><li>• CPAP, bilevel and ventilation devices (including external power supply units)</li><li>• Battery accessories</li><li>• Portable diagnostic/screening devices</li></ul>	2 years

This warranty is only available to the initial consumer. It is not transferable.

During the warranty period, if the product fails under conditions of normal use, ResMed will repair or replace, at its option, the defective product or any of its components.

This limited warranty does not cover: a) any damage caused as a result of improper use, abuse, modification or alteration of the product; b) repairs carried out by any service organization that has not been expressly authorized by ResMed to perform such repairs; c) any damage or contamination due to cigarette, pipe, cigar or other smoke;

and d) any damage caused by exposure to ozone, activated oxygen or other gasses.

Warranty is void on product sold, or resold, outside the region of original purchase.

Warranty claims on defective product must be made by the initial consumer at the point of purchase.

This warranty replaces all other expressed or implied warranties, including any implied warranty of merchantability or fitness for a particular purpose. Some regions or states do not allow limitations on how long an implied warranty lasts, so the above limitation may not apply to you.

ResMed shall not be responsible for any incidental or consequential damages claimed to have resulted from the sale, installation or use of any ResMed product. Some regions or states do not allow the exclusion or limitation of incidental or consequential damages, so the above limitation may not apply to you.

This warranty gives you specific legal rights, and you may also have other rights which vary from region to region. For further information on your warranty rights, contact your local ResMed dealer or ResMed office.

Visit [ResMed.com](http://ResMed.com) for the latest information on ResMed's Limited Warranty.

## **Further information**

If you require additional information on how to setup, use or maintain the Air11™ system (including ClimateLineAir heated tubing), or to report unexpected operation or events, please contact the ResMed Service Centre or your care provider.



**ResMed Pty Ltd**  
1 Elizabeth Macarthur Drive  
Bella Vista NSW 2153 Australia

See [ResMed.com](http://ResMed.com) for other ResMed locations worldwide. AirSense, ClimateLine, ClimateLineAir and HumidAir are trademarks and/or registered trademarks of the ResMed family of companies. For patent and other intellectual property information, see [ResMed.com/ip](http://ResMed.com/ip) © 2020 ResMed. 398108/1 2020-12

**ResMed.com**



398108